



ROOTED IN RESILIENCE

CENTERING CLIMATE & COMMUNITY

AGENDA & CAMPUS MAP

8:00 AM	Registration (Campus Center)
9:00 AM	Welcome & Keynote (Wright)
10:20 AM	Workshop Session I (Seelye)
11:30 AM	Facilitated Discussions (Campus Center)
12:40 PM	Lunch (Campus Center)
1:40 PM	Hands-On Activities (Campus Center)
2:30 PM	Workshop Session II (Seelye)
3:30 PM	End of Conference: Fill Out Survey!



FULL PROGRAM

SESSION I (SEELYE)

- Becoming a Successful Advocate **(201)**
- Beyond STEM **(206)**
- Centering Sea **(101)**
- Grow Food, Grow Community **(110)**
- Growing Environmental Stewards **(312)**
- Kids in the Garden **(301)**
- Plant-Powered Menus **(106)**
- Teaching the Truth **(109)**

SESSION II (SEELYE)

- Beyond the Poofy Squish **(101)**
- Building an Equitable Food Economy **(109)**
- Empowering Youth **(206)**
- How to Start & Grow Your F2S Program **(201)**
- Practicing Community Relationships **(110)**
- Reading and Eating for Equity **(106)**
- Resiliency in the Local Fishing Comm. **(312)**
- Restoring Climate Balance **(301)**

FACILITATED DISCUSSIONS (CAMPUS CENTER)

- Culinary Approaches to Waste Reduction **(104)**
- Farm Based Education **(201)**
- Greenhouses are Great **(208)**
- MA FRESH Grantees **(102)**
- Procurement **(202)**
- School Gardens & Curr. **(204)**
- School Wellness Policies **(003)**
- Conn. Youth Food & Climate Justice **(203)**

HANDS-ON ACTIVITIES (CAMPUS CENTER)

- Activist Art Projects **(203)**
- Culinary Fun: Pickles **(104)**
- Hydroponics in Action **(Exh Fair)**
- Pollinators **(204)**
- Procurement Consulting **(201)**
- Record Your F2S Story **(102)**
- Soil Health & Min. Till **(001)**
- Take Action for Farm to School **(Main Lev.)**
- Vermicomposting **(001)**

WiFi

Network: Connect2Smith
 Password: sophiesmith

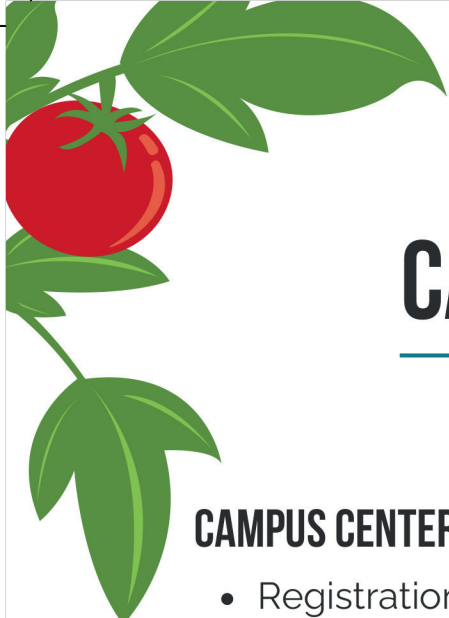

CAMPUS MAP

CAMPUS CENTER

- Registration
- Facilitated Discussions
- Lunch
- Hands-On Activities
- Exhibitor Fair

WRIGHT: AUDITORIUM

- Keynote Address

SEELYE HALL

- Workshop Session I
- Workshop Session II

PARKING

- Parking Pass Required*

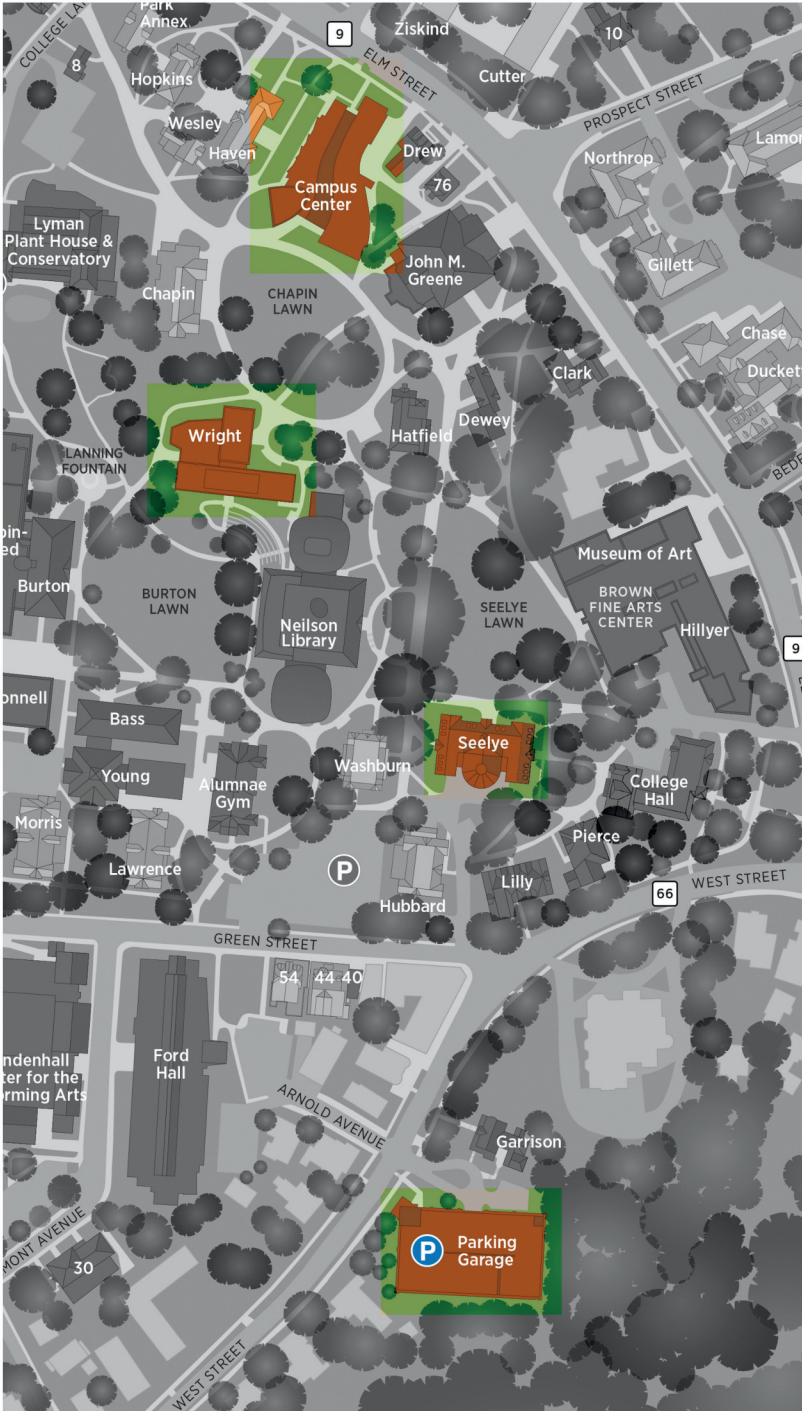

**Parking pass emailed to all registrants*